

## Magnetventile/Solenoid valves

Scem/Parker



| Abb. Pict. | Best.-Nr. Ord.-No. | Beschreibung Description                                 | Vergl.-Nr. Comp.-No. |
|------------|--------------------|--|----------------------|
| 1          | 370057             | kpl., 3 Wege, 230VAC<br>cpl., 3 ways, 230VAC             | 18157                |
| 2          | 370062             | Ventilkörper<br>Solenoid square pin                      |                      |
| 3          | 370206             | kpl., 1/8", 2 Wege, 230VAC<br>cpl., 1/8", 2 ways, 230VAC | 18162<br>18161       |
| 4          | 371029             | Magnetspule, 230VAC<br>Magnetic coil, 230VAC             |                      |

Lucifer



| Abb. Pict. | Best.-Nr. Ord.-No. | Beschreibung Description                                 | Vergl.-Nr. Comp.-No. |
|------------|--------------------|--|----------------------|
| 1          | 370053             | kpl., 3 Wege, 230VAC<br>cpl., 3 ways, 230VAC             | 18153<br>18151       |
| 2          | 370061             | Ventilkörper<br>Solenoid square pin                      |                      |
| 3          | 370072             | kpl., 1/8", 2 Wege, 230VAC<br>cpl., 1/8", 2 ways, 230VAC | 18164                |
| 4          | 371031             | Magnetspule, 230VAC<br>Magnetic coil, 230VAC             |                      |

ODE



| Abb. Pict. | Best.-Nr. Ord.-No. | Beschreibung Description                                 | Vergl.-Nr. Comp.-No. |
|------------|--------------------|--|----------------------|
| 1          | 370203             | kpl., 3 Wege, 230VAC<br>cpl., 3 ways, 230VAC             |                      |
| 2          | 371150             | Magnetspule, 230VAC<br>Magnetic coil, 230VAC             |                      |
| 3          | 370168             | kpl., 1/8", 2 Wege, 230VAC<br>cpl., 1/8", 2 ways, 230VAC | 18171<br>18172       |
| 4          | 371071             | Magnetspule, 230VAC<br>Magnetic coil, 230VAC             |                      |

Sirai



| Abb. Pict. | Best.-Nr. Ord.-No. | Beschreibung Description                                 | Vergl.-Nr. Comp.-No. |
|------------|--------------------|--|----------------------|
| 1          | 370203             | kpl., 3 Wege, 230VAC<br>cpl., 3 ways, 230VAC             |                      |
| 2          | 371150             | Magnetspule, 230VAC<br>Magnetic coil, 230VAC             |                      |
| 3          | 370168             | kpl., 1/8", 2 Wege, 230VAC<br>cpl., 1/8", 2 ways, 230VAC | 18171<br>18172       |
| 4          | 371071             | Magnetspule, 230VAC<br>Magnetic coil, 230VAC             |                      |

## Magnetventile Zubehör/Solenoid valve accessories



| Abb. Pict. | Bestell-Nr. Order-No. | Beschreibung Description         | Vergl.-Nr. Comp.-No. |
|------------|-----------------------|----------------------------------|----------------------|
| 1          | 371091                | Stecker/klein<br>Plug/small      |                      |
| 2          | 371090                | Stecker/groß<br>Plug/big         | 18110                |
| 3          | 371095                | O-Ring/Viton<br>O-Ring/viton     | 12305                |
| 4          | 371100                | O-Ring/Silikon<br>O-Ring/Silicon |                      |

## Pressostate/Schalter/Pressure switches/switches



| Abb. Pict. | Bestell-Nr. Order-No. | Beschreibung Description                  | Vergl.-Nr. Comp.-No. |
|------------|-----------------------|---|----------------------|
| 1          | 541021                | Pressostat<br>Pressure switch             |                      |
| 2          | 520139                | Membranen-Satz<br>Membrane-set            |                      |
| 3          | 541089                | Pressostat, 1/8"<br>Pressure switch, 1/8" | 20155                |

## Hauptschalter/Main switches



| Abb. Pict. | Bestell-Nr. Order-No. | Beschreibung Description                                     | Vergl.-Nr. Comp.-No. |
|------------|-----------------------|--|----------------------|
| 1          | 346104                | Schalter, 0 - I, 3-pol, 20A<br>Switch, 0 - I, 3-pol, 20A     | 18201<br>18211       |
| 2          | 346105                | Schalter, 0 - I, 3-pol, 32A<br>Switch, 0 - I, 3-pol, 32A     | 18207                |
| 3          | 346100                | Umschalter, I - 0 - 2, 20A<br>Changer-switch, I - 0 - 2, 20A | 18104                |

## Hauptschalter/Main switches



| Abb. Pict. | Best.-Nr. Ord.-No. | Beschreibung Description               | Gerätetyp Device type | Vergl.-Nr. Comp.-No. |
|------------|--------------------|--|-----------------------|----------------------|
| 1          | 346101             | Umschalter, 32A<br>Changer-switch, 32A |                       | 18105                |
| 2          | 110205             | Knebel<br>Knob                         |                       | 15271                |
| 3          | 111155             | Knebel<br>Knob                         | Brava                 | 15277999             |

## Relais/Relays

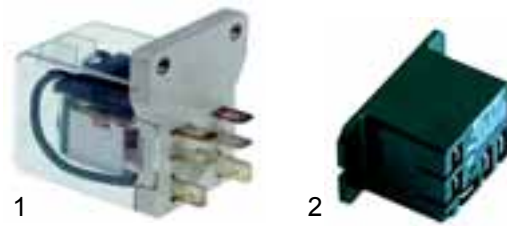

| Abb. Pict. | Best.-Nr. Ord.-No. | Beschreibung Description          | Gerätetyp Device type | Vergl.-Nr. Comp.-No. |
|------------|--------------------|-----------------------------------|-----------------------|----------------------|
| 1          | 380315             | 2 Schließer, 16A<br>2 closer, 16A | Compact               | 18452                |
| 2          | 380307             | 1 Wechsler, 16A<br>1 changer, 16A |                       | 18460001             |

## Schalter/Switches (30 x 22mm)



| Abb. Pict. | B.-Nr. O.-No. | Beschreibung Description                                    | Gerätetyp Device type                 | Ver.-Nr. Com.-No. |
|------------|---------------|---|---------------------------------------|-------------------|
| 1          | 301020        | Taster (beleuchtet/rot)<br>Push button (lighted/red)        | Compact                               | 18266             |
| 1          | 301001        | Schalter (beleuchtet/rot)<br>Switch (lighted/red)           | Compact<br>Argenta<br>Brava<br>Divina | 18260             |
| 2          | 301015        | Umschalter (beleuchtet/rot)<br>Changer-switch (lighted/red) | Compact                               | 18135             |
| 3          | 301009        | Schalter (beleuchtet/klar)<br>Switch (lighted/clear)        | Argenta<br>Brava                      | 18262             |
| 4          | 301036        | Schutzhaube<br>Protecting cover                             | Compact                               | 19049             |

## Thermostate/Thermostats

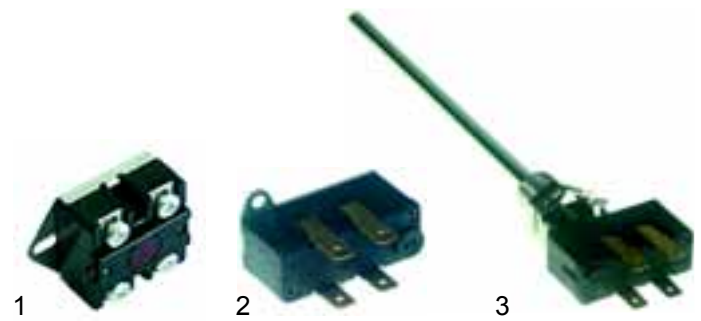

| Abb. Pict. | Best.-Nr. Ord.-No. | Beschreibung Description   | Vergl.-Nr. Comp.-No. |
|------------|--------------------|--|----------------------|
| 1          | 390431             | Sicherheitsthermostat, 2-pol, 40A, 250V<br>Safety thermostat, 2-pol, 40A, 250V | 20300006             |
| 2          | 390434             | Sicherheitsthermostat, 2-pol, 20A, 400V<br>Safety thermostat, 2-pol, 20A, 400V | 20301                |
| 3          | 390433             | Sicherheitsthermostat, 2-pol, 20A, 400V<br>Safety thermostat, 2-pol, 20A, 400V | 20302                |



| Abb. Pict. | B.-Nr. O.-No. | Beschreibung Description               | Einbau Fitting | Gerätetyp Device type | V.-Nr. C.-No. |
|------------|---------------|--|----------------|-----------------------|---------------|
| 1          | 345037        | Gruppenschalter<br>Group switch        | Ø25mm          | Brava                 | 18245         |
| 2          | 301025        | Gruppenschalter<br>Group switch        | 28x24mm        |                       |               |
| 3          | 359413        | Signallampe<br>Signal lamp             |                |                       | 21030         |
| 4          | 359139        | Signallampe, 230V<br>Signal lamp       | 10mm           |                       | 21011         |
| 4          | 359019        | Signallampe, 400V<br>Signal lamp, 400V | 10mm           |                       | 21012         |



| Abb. Pict. | Best.-Nr. Ord.-No. | Beschreibung Description   | V.-Nr. C.-No. |
|------------|--------------------|--|---------------|
| 1          | 390436             | Anlegethermostat, 100°, 16A, 250V<br>Stoke thermostat, 100°, 16A, 250V             | 20300009      |
| 2          | 390435             | Anlegethermostat, 180°, 16A, 250V<br>Stoke thermostat, 180°, 16A, 250V             | 20300011      |
| 3          | 390370             | Sicherheitsthermostat, 145°, M4-16A, 250V<br>Safety thermostat, 145°, M4-16A, 250V | 20304         |

Passend für/Suitable for Astoria

## Niveauregler/Level controllers



| Abb. Pict. | Best.-Nr. Ord.-No. | Beschreibung Description     | Gerätetyp Device type | V.-Nr. C.-No. |
|------------|--------------------|------------------------------|-----------------------|---------------|
| 1          | 400530             | RMFC2SN, 230V                | Compact               | 18045         |
| 2          | 400019             | RL 30/1E-2C/F, 230V          | Argenta               | 18080         |
| 3          | 400537             | RL 30/1E-2C/F Time Out, 230V | Brava, Divina         | 18080001      |
| 4          | 400538             | Led Time Out                 | Divina                | 22625         |



| Abb. Pict. | Bestell.-Nr. Order-No. | Beschreibung Description                 | Gerätetyp Device type           | Ver.-Nr. Com.-No. |
|------------|------------------------|--|---------------------------------|-------------------|
| 1          | 400017                 | RL 30/1E-2C/11, 230V                     |                                 |                   |
| 2          | 400230                 | RL 40/1E/11, 230V                        |                                 | 18402             |
| 3          | 380136                 | Socket, 11-pole<br>Base, 11 poles        | Argenta, Brava, Compact, Divina | 18600             |
| 4          | 400020                 | Niveausonde, 160mm<br>Level probe, 160mm |                                 | 20251             |
| 4          | 400551                 | Niveausonde, 255mm<br>Level probe, 255mm |                                 | 20252             |

## Elektronik, Tastaturen/Electronics, Keyboards

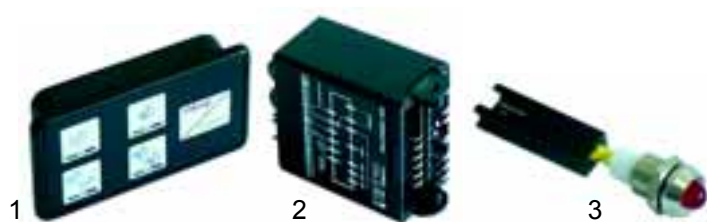

| Abb. Pict. | Bestell.-Nr. Order-No. | Beschreibung Description                   | Gerätetyp Device type | Ver.-Nr. Com.-No. |
|------------|------------------------|--|-----------------------|-------------------|
| 1          | 400532                 | 5 Tasten<br>5 push buttons                 | Compact               | 18371008          |
| 2          | 400531                 | Zentraleinheit, 1Gr<br>Electronic box, 1gr | Compact               | 18045001          |
| 3          | 400538                 | Led  | Compact               | 22623             |

## Elektronik, Tastaturen/Electronics, key push buttons



| Abb. Pict. | Bestell.-Nr. Order-No. | Beschreibung Description                           | Gerätetyp Device type | Ver.-Nr. Com.-No. |
|------------|------------------------|--|-----------------------|-------------------|
| 1          | 400540                 | 5 Tasten<br>5 push buttons                         | Brava                 | 18359             |
| 2          | 400541                 | 6 Tasten<br>6 push buttons                         | Brava                 | 18359001          |
| 3          | 400539                 | Zentraleinheit, 1 - 3Gr<br>Electronic box, 1 - 3gr | Brava                 | 18090016          |

## Elektronik, Tastaturen/Electronics, key push button

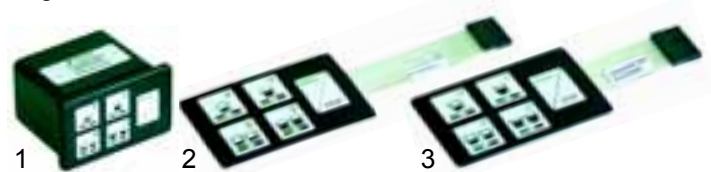

| Abb. Pict. | Best.-Nr. Ord.-No. | Beschreibung Description                       | Gerätetyp Device type | Ver.-Nr. Com.-No. |
|------------|--------------------|--|-----------------------|-------------------|
| 1          | 400353             | 5 Tasten, 9.910.63<br>5 push buttons, 9.910.63 | Argenta               | 18354             |
| 2          | 400536             | 5 Tasten, Gicar<br>5 push buttons              | Argenta               | 20100             |
| 3          | 400535             | 5 Tasten, Giemme<br>5 push buttons             | Argenta               | 20099001          |



| Abb. Pict. | Bestell.-Nr. Order-No. | Beschreibung Description                      | Gerätetyp Device type | Ver.-Nr. Com.-No. |
|------------|------------------------|---|-----------------------|-------------------|
| 1          | 400379                 | Elektronik-Box, 1-3G<br>Electronic box, 1-3gr | Argenta               | 18079<br>18076    |

## Elektronik, Tastaturen/Electronics, key push button



| Abb. Pict. | Best.-Nr. Ord.-No. | Beschreibung Description                            | Gerätetyp Device type | Ver.-Nr. Com.-No. |
|------------|--------------------|---|-----------------------|-------------------|
| 1          | 400542             | 5 Tasten TH, 9.5.17.62<br>5 push buttons, 9.5.17.62 | Junior (Elektronik)   | 18371010          |
| 2          | 400547             | 1 Schalter (Kaffee)<br>1 switch (coffee)            | Junior (Manuell)      | 18371017          |



## Elektronik, Tastaturen/Electronic, key push buttons Divina



| Abb. Pict. | B.-Nr. O.-No. | Beschreibung Description                          | Gerätetyp Device type              | V.-Nr. C.-No. |
|------------|---------------|---|------------------------------------|---------------|
| 1          | 400543        | 4 Tasten TH, 9.2.2056<br>4 push buttons, 9.2.2056 | Zeitsteuerung<br>Timing regulation | 21276         |
| 2          | 400545        | 2 Schalter (Kaffee)<br>2 switches (coffee)        |                                    | 18371018      |



| Abb. Pict. | Bestell-Nr. Order-No. | Beschreibung Description   | Gerätetyp Device type | Ver.-Nr. Com.-No. |
|------------|-----------------------|--|-----------------------|-------------------|
| 1          | 400546                | 1 Schalter (Kaffee)<br>1 switch (coffee)<br>1 Taster (Wasser)<br>1 push button (water) | AEP                   | 18371021          |
| 2          | 400547                | 1 Schalter (Kaffee)<br>1 switch (coffee)   | AEP                   | 18371017          |



| Abb. Pict. | Bestell-Nr. Order-No. | Beschreibung Description   | Gerätetyp Device type | Ver.-Nr. Com.-No. |
|------------|-----------------------|--|-----------------------|-------------------|
| 1          | 400550                | 5 Tasten<br>5 push buttons   | SAE                   | 18371016          |
| 2          | 400549                | 2 Schalter (Kaffee)<br>1 Taster (Wasser)<br>2 switches (coffee)<br>1 push button (water) | SAE                   | 18371020          |
| 3          | 400548                | 1 Schalter (Kaffee)<br>1 Taster (Wasser)<br>1 switches (coffee)<br>1 push button (water) | SAE                   | 18371019          |



| Pos. Item | Bestell-Nr. Order-No. | Beschreibung Description                       | Gerätetyp Device type | Ver.-Nr. Com.-No. |
|-----------|-----------------------|--|-----------------------|-------------------|
| 1         | 400544                | Zentraleinheit, 1-3Gr<br>Electronic box, 1-3gr | SAE                   | 18090008          |

## Elektronik, Tastaturen/Electronic, key push buttons Divina



| Abb. Pict. | B.-Nr. O.-No. | Beschreibung Description   | Gerätetyp Device type | V.-Nr. C.-No. |
|------------|---------------|--|-----------------------|---------------|
| 1          | 400350        | 4 Tasten, Zeitsteuerung,<br>9.2.20.51<br>4 push buttons,<br>timing regulation, 9.2.20.51 |                       | 21274         |
| 2          | 400352        | 5 Tasten, DOS TH, 1Gr<br>5 push buttons, DOS TH, 1gr                                     |                       | 18365         |

## Elektronik, Flowmeter/Electronics, Flowmeter



| Abb. Pict. | Bestell-Nr. Order-No. | Beschreibung Description           | Gerätetyp Device type | Vergl.-Nr. Comp.-No. |
|------------|-----------------------|------------------------------------|-----------------------|----------------------|
| 1          | 400004                | Flowmeter, 1/4"<br>Flowmeter, 1/4" |                       | 18126                |
| 2          | 400256                | Stecker<br>Plugs                   | Argenta,<br>Brava,    |                      |
| 3          | 400257                | Zählrad<br>Flowmeter reel          | Compact,<br>Divina    | 13505                |
| 4          | 400258                | Gehäusedichtung<br>Case gasket     |                       | 12315                |

## Pumpen/Pumps



| Abb. Pict. | Bestell-Nr. Order-No. | Beschreibung Description | Gerätetyp Device type     | Vergl.-Nr. Comp.-No. |
|------------|-----------------------|--------------------------|---------------------------|----------------------|
| 1          | 500227                | ULKA NME Typ 4           | Prima                     | 26318                |
| 2          | 500173                | ULKA EP5                 | Prima                     | 26316                |
| 3          | 500123                | Fluid-O-Tech             | Compact<br>Argenta Junior | 26304                |

## Motoren/Engines

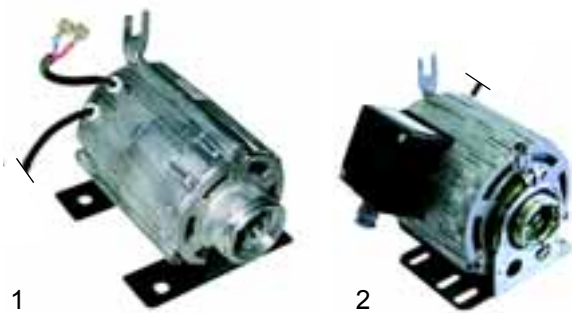

| Abb. Pict. | Bestell-Nr. Order-No. | Beschreibung Description | Gerätetyp Device type  | Vergl.-Nr. Comp.-No. |
|------------|-----------------------|--------------------------|------------------------|----------------------|
| 1          | 500072                | RPM, 100W                | Compact                | 18304                |
| 2          | 500061                | RPM, 165W                | Argenta, Brava, Divina | 18300, 18301, 18312  |



| Abb. Pict. | Bestell-Nr. Order-No. | Beschreibung Description | Gerätetyp Device type  | Vergl.-Nr. Comp.-No. |
|------------|-----------------------|--------------------------|------------------------|----------------------|
| 1          | 500225                | RPM                      | Argenta, Brava, Divina | 56406                |
| 2          | 500226                | Zecchin                  |                        | 56402                |

## Pumpen/Pumps



| Abb. Pict. | B.-Nr. O.-No. | Beschreibung Description | Gerätetyp Device type  | V.-Nr. C.-No. |
|------------|---------------|--------------------------|------------------------|---------------|
| 1          | 500064        | Fluid-O-Tech, 200l/h     | Argenta, Brava, Divina | 26303         |
| 2          | 500230        | Procon, 200l/h           |                        | 26302         |

## Heizkörper/Heaters



| Abb. Pict. | Best.-Nr. Ord.-No. | Beschreibung Description           | Gerätetyp Device type | Ver.-Nr. Com.-No. |
|------------|--------------------|------------------------------------|-----------------------|-------------------|
| 1          | 417162             | 800W, 230V                         | Prima                 | 17301             |
| 2          | 417089             | 1300W, 230V, 1 1/4"                | Compact               | 17201             |
| 3          | 528021             | Dichtung, 1 1/4"<br>Gasket, 1 1/4" | Compact               | 12001             |

### 2-kreisig (4-polig)/2 circuits (4 poles)



| Abb. Pict. | Best.-Nr. Ord.-No. | Beschreibung Description | Gerätetyp Device type  | Ver.-Nr. Com.-No. |
|------------|--------------------|--------------------------|------------------------|-------------------|
| 1          | 417039             | 2000W, 230-240V, 1Gr     | Argenta, Brava, Divina | 17002             |
| 2          | 417040             | 2600W, 230-240V, 2Gr     |                        | 17051             |
| 3          | 417064             | 3700W, 230-240V, 3Gr     |                        | 17101             |

### 3-kreisig (6-polig)/3 circuits (6 poles)



| Abb. Pict. | Best.-Nr. Ord.-No. | Beschreibung Description | Gerätetyp Device type  | V.-Nr. C.-No. |
|------------|--------------------|--------------------------|------------------------|---------------|
| 1          | 417043             | 1800W, 230V/400V, 1Gr    | Junior                 | 17006         |
| 2          | 417087             | 2600W, 230V/400V, 2Gr    | Argenta, Brava, Divina | 17054         |
| 3          | 417088             | 3700W, 230V/400V, 3Gr    |                        | 17104         |

## Heizkörper/Heaters

### 3-kreisig (6-polig)/3 circuits (6 poles)



| Abb. Pict. | Best.-Nr. Ord.-No. | Beschreibung Description | Gerätetyp Device type | Ver.-Nr. Com.-No. |
|------------|--------------------|--------------------------|-----------------------|-------------------|
| 1          | 528001             | Dichtung<br>Gasket       | Universal             | 12001             |
| 2          | 528002             | Dichtung<br>Gasket       | Universal             | 12001             |

## Kesseldichtungen/Pot gaskets



| Abb. Pict. | Best.-Nr. Ord.-No. | Beschreibung Description | Gerätetyp Device type | Ver.-Nr. Com.-No. |
|------------|--------------------|--------------------------|-----------------------|-------------------|
| 1          | 528150             | 190 x 140 x 3mm          | Universal             | 12003             |
| 2          | 528151             | 190 x 140 x 2mm          | Universal             | 12003             |

## Manometer/Manometers



| Abb. Pict. | Best.-Nr. Ord.-No. | Beschreibung Description  | Gerätetyp Device type | Ver.-Nr. Com.-No. |
|------------|--------------------|---|-----------------------|-------------------|
| 1          | 541261             | 1/8", 2,5bar, 40mm  | Compact               | 21105             |
| 2          | 541225             | 1/4", 3bar, 52mm  | Hebel                 | 21101             |
| 3          | 541223             | 1/8", 2,5/16bar, 60mm, Doppelskala, 1/8", 2,5/16bar, 60mm, double scale | Argenta               | 21100<br>21104    |



| Abb. Pict. | Best.-Nr. Ord.-No. | Beschreibung Description | Gerätetyp Device type | Ver.-Nr. Com.-No. |
|------------|--------------------|--------------------------|-----------------------|-------------------|
| 1          | 541262             | 1/8", 3,0/15bar, 60m     | Brava                 | 21112             |
| 2          | 541263             | 1/8", 2,5/16bar, 60m     | Divina                | 21109             |

## Ventile/Valves



| Abb. Pict. | Best.-Nr. Ord.-No. | Beschreibung Description                                   | Gerätetyp Device type | V.-Nr. C.-No.  |
|------------|--------------------|--|-----------------------|----------------|
| 1          | 529331             | Sicherheitsventil, 1/8" Safety valve, 1/8"                 |                       | 20357          |
| 2          | 529312             | Sicherheitsventil, 3/8" Safety valve, 3/8"                 |                       | 20350          |
| 3          | 529316             | Sicherheitsventil, 3/8" Safety valve, 3/8"                 | Ispel                 | 20356          |
| 4          | 529332             | Sicherheitsventil, 1,8bar, 3/8" Safety valve, 1,8bar, 3/8" | TÜV, CE               | 20352<br>20351 |

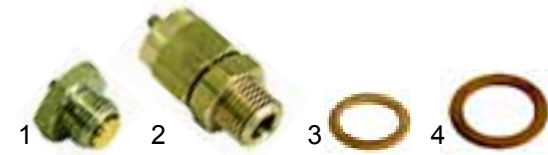

| Abb. Pict. | Best.-Nr. Ord.-No. | Beschreibung Description                  | Gerätetyp Device type | V.-Nr. C.-No. |
|------------|--------------------|---|-----------------------|---------------|
| 1          | 529303             | Entlüftungsventil, 1/4" Empty valve, 1/4" |                       |               |
| 2          | 529304             | Entlüftungsventil, 1/4" Empty valve, 1/4" |                       | 56150         |
| 3          | 529361             | Cu-Dichtung, 1/4" Cu-gasket, 1/4"         |                       | 12153         |
| 4          | 529349             | Cu-Dichtung, 3/8" Cu-gasket, 3/8"         |                       | 12101         |



| Abb. Pict. | Best.-Nr. Ord.-No. | Beschreibung Description                                   | Gerätetyp Device type | V.-Nr. C.-No. |
|------------|--------------------|--|-----------------------|---------------|
| 1          | 529335             | Rückschlagventil, 1/8" Non-return valve, 1/8"              | Compact               | 20358         |
| 2          | 529301             | Rückschlagventil, 3/8" Non-return valve, 3/8"              | Argenta               | 56151         |
| 3          | 529337             | Expansionsventil, 3/8" - 1/4" Expansion valve, 3/8" - 1/4" | Argenta               | 56152         |



## Ventile/Valves



| Abb. Pict. | B.-Nr. O.-No. | Beschreibung Description                                      | Gerätetyp Device type  | V.-Nr. C.-No. |
|------------|---------------|---|------------------------|---------------|
| 1          | 529336        | Expansionsventil, 3/8" - 1/2"<br>Expansion valve, 3/8" - 1/2" | Compact                | 56210         |
| 2          | 529333        | SCNR-Ventil<br>SCNR-valve                                     | Argenta, Brava, Divina | 20361         |
| 3          | 529334        | Expansionsventil, 10bar<br>Expansion valve, 10bar             | Junior                 | 56300         |

## Wasserstandsglas/Water level glass

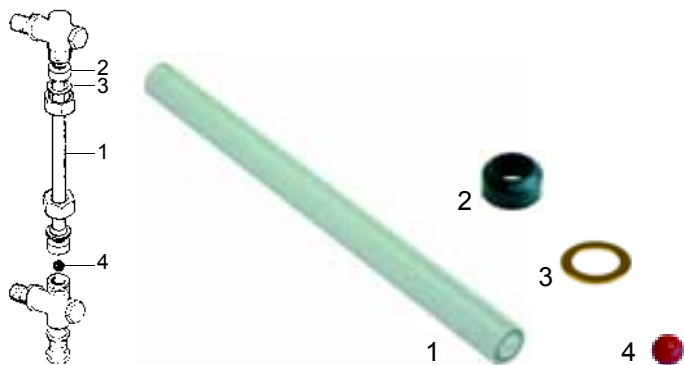

| Abb. Pict. | B.-Nr. O.-No. | Beschreibung Description                                | Gerätetyp Device type | V.-Nr. C.-No. |
|------------|---------------|---|-----------------------|---------------|
| 1          | 529407        | Wasserstandsglas, 170 x 11mm<br>Level glass, 170 x 11mm |                       | 21300         |
| 2          | 529408        | Wasserstandsglasdichtung<br>Level glass gasket          |                       | 12200         |
| 3          | 529862        | Druckscheibe<br>Pressure washer                         |                       | 25652         |
| 4          | 529355        | Plastikkugel<br>Plastic ball                            |                       | 15300         |

## Wasserfüllventil/Water intake valve

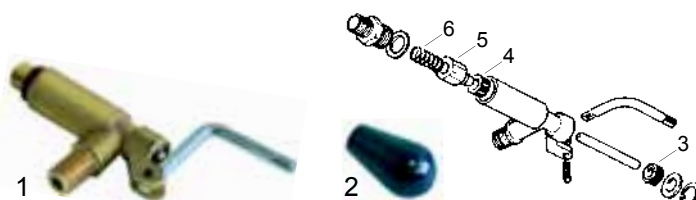

| Abb. Pict. | B.-Nr. O.-No. | Beschreibung Description                                 | Gerätetyp Device type  | V.-Nr. C.-No. |
|------------|---------------|--|------------------------|---------------|
| 1          | 529632        | Wasserfüllventil komplett<br>Water intake valve assembly | Compact                | 56210         |
| 2          | 111092        | Griff M8<br>Knob M8                                      | Argenta, Brava, Divina | 20361         |



|   |        |                                 |  |       |
|---|--------|---------------------------------|--|-------|
| 3 | 528309 | Dichtung<br>Gasket              |  | 12205 |
| 4 | 528308 | Kolbendichtung<br>Piston gasket |  | 12203 |
| 5 | 528310 | Kolben<br>Piston                |  | 25615 |
| 6 | 528311 | Feder<br>Spring                 |  | 10451 |



| Abb. Pict. | Bestell-Nr. Order-No. | Beschreibung Description         | Gerätetyp Device type | Vergl.-Nr. Comp.-No. |
|------------|-----------------------|----------------------------------|-----------------------|----------------------|
| 1          | 529770                | Dampfhahn/kpl.<br>Steam tap/cpl. | Compact               | 56110                |
| 2          | 111151                | Knebel<br>Knob                   | Compact               | 15251                |

## Hähne/Taps



| Abb. Pict. | Bestell-Nr. Order-No. | Beschreibung Description        | Gerätetyp Device type | Vergl.-Nr. Comp.-No. |
|------------|-----------------------|---------------------------------|-----------------------|----------------------|
| 1          | 529621                | Hahn/kpl. Tap/cpl.              |                       |                      |
| 2          | 529670                | Körper Body                     |                       | 53003                |
| 3          | 529658                | Vorderteil/kpl. Front part/cpl. |                       | 56100                |

## Knebel/Knobs



| Abb. Pict. | Bestell-Nr. Order-No. | Beschreibung Description | Gerätetyp Device type | Vergl.-Nr. Comp.-No. |
|------------|-----------------------|--------------------------|-----------------------|----------------------|
| 1          | 111153                | Wasser Water             | Brava                 | 15277998             |
| 2          | 111154                | Dampf Steam              | Brava                 | 15277997             |
| 3          | 111157                | Wasser Water             | Divina                | 15276                |
| 4          | 111158                | Dampf Steam              | Divina                | 15275                |

## Rohre/Pipes

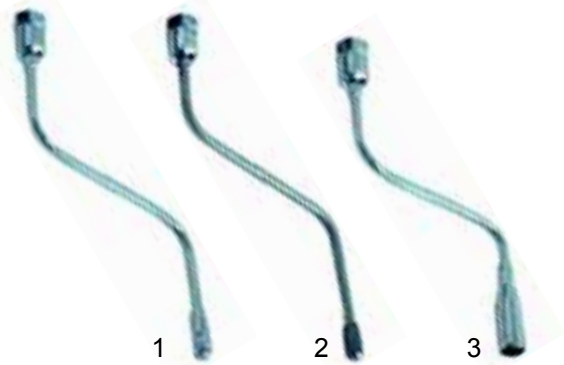

| Abb. Pict. | Bestell-Nr. Order-No. | Beschreibung Description                    | Gerätetyp Device type | Vergl.-Nr. Comp.-No. |
|------------|-----------------------|---|-----------------------|----------------------|
| 4          | 528308                | Dichtung, 15 x 4 x 4mm Gasket, 15 x 4 x 4mm |                       | 12203                |
| 5          | 528312                | Dichtung Gasket                             |                       | 20350                |
| 6          | 528313                | Wellendichtung Shaft gasket                 |                       | 12204                |
| 7          | 529719                | Feder, 11,5 x 16mm Spring, 11,5 x 16mm      |                       | 10452                |
| 1          | 529775                | Dampf, VC, 285m Steam, VC, 285m             | Argenta               | 90312                |
| 1          | 529622                | Dampf, VC, 320m Steam, VC, 320m             | Argenta               | 90313                |
| 2          | 529773                | Dampf, CNS, 285m Steam, CNS 285m            | Argenta               | 90310                |
| 2          | 529772                | Dampf, CNS 320m Steam, CNS 320m             | Argenta               | 90309                |
| 3          | 529776                | Wasser Water                                | Argenta               | 90321                |

## Knebel/Knobs



| Abb. Pict. | Bestell-Nr. Order-No. | Beschreibung Description | Gerätetyp Device type  | Vergl.-Nr. Comp.-No. |
|------------|-----------------------|--------------------------|------------------------|----------------------|
| 1          | 111156                | Wasser Water             | Alte Serien Old series | 15253                |
| 2          | 111090                | Dampf Steam              | Alte Serien Old series | 15254                |
| 3          | 111152                | Wasser Water             | Argenta                | 15264                |
| 4          | 111091                | Dampf Steam              | Argenta                | 15265                |

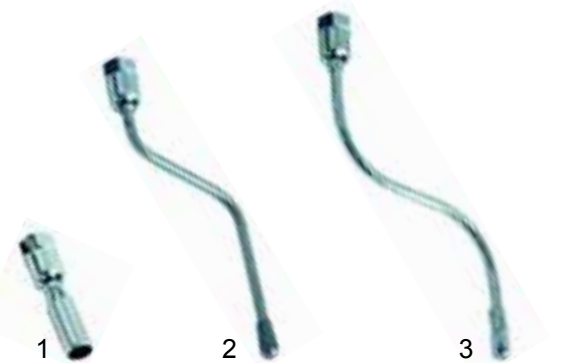

| Abb. Pict. | Bestell-Nr. Order-No. | Beschreibung Description          | Gerätetyp Device type | Vergl.-Nr. Comp.-No. |
|------------|-----------------------|-----------------------------------|-----------------------|----------------------|
| 1          | 529771                | Wasser Water                      | Compact               | 56119024             |
| 2          | 529777                | Dampf, CNS Steam, stainless steel | Brava                 | 56108                |
| 3          | 529774                | Dampf, VC Steam, VC               | Alt                   | 90311                |



## Rohrzubehör/Accessories for pipes

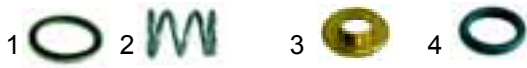

| Abb. Pict. | Bestell-Nr. Order-No. | Beschreibung Description             | Gerätetyp Device type     | Vergl.-Nr. Comp.-No. |
|------------|-----------------------|--------------------------------------|---------------------------|----------------------|
| 1          | 528210                | Dichtung<br>Gasket                   |                           |                      |
| 1          | 528314                | Dichtung (Teflon)<br>Gasket (teflon) |                           | 12010                |
| 2          | 529719                | Feder<br>Spring                      | Alt<br>Compact<br>Argenta | 10452                |
| 3          | 529718                | Druckscheibe<br>Pressure washer      | Brava                     | 25657                |
| 4          | 529412                | O-Ring<br>O-ring                     |                           | 12300                |



| Abb. Pict. | Bestell-Nr. Order-No. | Beschreibung Description             | Gerätetyp Device type | Vergl.-Nr. Comp.-No. |
|------------|-----------------------|--------------------------------------|-----------------------|----------------------|
| 1          | 529778                | Dampf (CNS)<br>Steam (CNS)           | Divina                | 83250002             |
| 2          | 528314                | Dichtung (Teflon)<br>Gasket (teflon) | Divina                | 12010                |
| 3          | 529735                | Feder<br>Spring                      | Divina                | 10465                |
| 4          | 529738                | Buchse (Teflon)<br>Bush (teflon)     | Divina                | 15191                |
| 5          | 529739                | O-Ring<br>O-ring                     | Divina                |                      |
| 6          | 529779                | Buchse/kpl.<br>Bush/cpl.             | Divina                |                      |

## Ablaufwanne/Drain tap

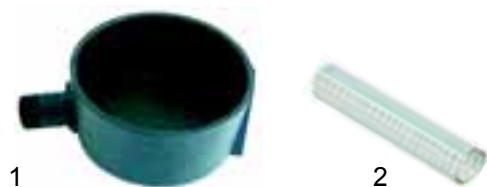

| Abb. Pict. | B.-Nr. O.-No. | Beschreibung Description  | Gerätetyp Device type | V.-Nr. C.-No. |
|------------|---------------|---|-----------------------|---------------|
| 1          | 528600        | Ablaufwanne 3/8"<br>Drain tap 3/8"                                |                       | 15502         |
| 2          | 520072        | Ablaufschlauch 3/8", VPE 5m<br>Outlet pipe 3/8", packaging 5m     |                       | 15470         |
| 2          | 520036        | Ablaufschlauch, 3/8", VPE 30m<br>Outlet pipe, 3/8", packaging 30m |                       | 15470         |

## Gruppe/Group



| Abb. Pict. | Best.-Nr. Ord.-No. | Beschreibung Description | Gerätetyp Device type               | Vergl.-Nr. Comp.-No. |
|------------|--------------------|--------------------------|-------------------------------------|----------------------|
| 1          | 525000             | Gruppe/kpl. Group/cpl.   | Compact                             | 56055                |
| 2          | 525002             | Gruppe/kpl. Group/cpl.   | Argenta Wärmetauscher/herausnehmbar | 56072                |
| 3          | 525001             | Gruppe/kpl. Group/cpl.   | Argenta Wärmetauscher/fest          | 56054                |

| Abb. Pict. | Bestell-Nr. Order-No. | Beschreibung Description | Gerätetyp Device type | Vergl.-Nr. Comp.-No. |
|------------|-----------------------|--------------------------|-----------------------|----------------------|
| 4          | 525004                | Gruppe/kpl. Group/cpl.   | Brava                 | 56082001             |
| 5          | 525003                | Gruppe/kpl. Group/cpl.   | Divina                | 56080                |

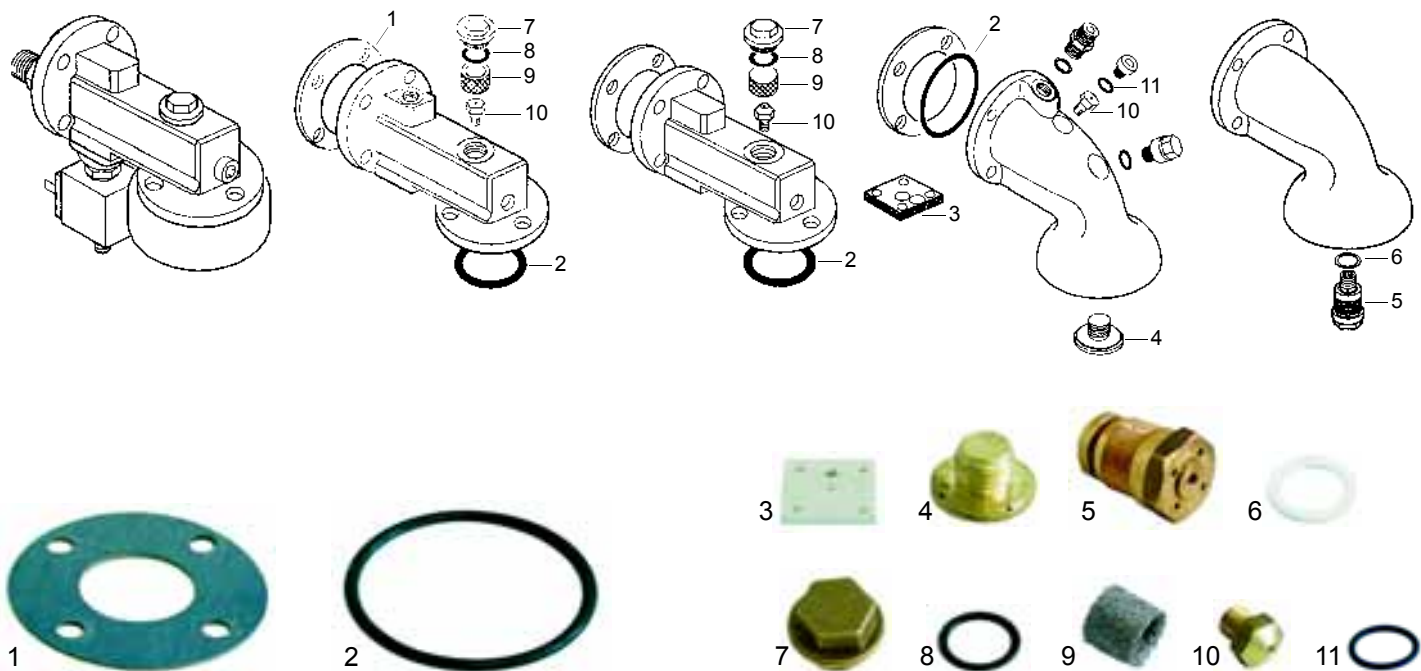

| Abb. Pict. | Bestell-Nr. Order-No. | Beschreibung Description          | Gerätetyp Device type | Vergl.-Nr. Comp.-No. |
|------------|-----------------------|-----------------------------------|-----------------------|----------------------|
| 1          | 528152                | Dichtung Gasket                   |                       | 12002                |
| 2          | 528178                | O-Ring O-ring                     |                       | 12304                |
| 3          | 528186                | Iso-Platte Iso-board              |                       | 12013                |
| 4          | 528174                | Verteiler Divider                 |                       | 25422004             |
| 5          | 528180                | Düseneinheit Nozzle unit          |                       | 25739500             |
| 6          | 528179                | Dichtung (Teflon) Gasket (teflon) |                       | 12012001             |
| 7          | 528316                | Schraubkappe Screw cap            |                       | 25789                |

| Abb. Pict. | Bestell-Nr. Order-No. | Beschreibung Description | Gerätetyp Device type | Ver.-Nr. Com.-No. |
|------------|-----------------------|--------------------------|-----------------------|-------------------|
| 8          | 528251                | O-Ring O-ring            |                       | 12303             |
| 9          | 528317                | Filter Filter            |                       | 10252             |
| 10         | 528175                | Düse, 0,6 Nozzle, 0,6    |                       | 10300A            |
| 10         | 528176                | Düse, 0,7 Nozzle, 0,7    |                       | 10300001          |
| 10         | 528177                | Düse, 0,8 Nozzle, 0,8    |                       | 10300             |
| 11         | 528950                | O-Ring O-ring            |                       | 12330             |

## Siebträgerdichtungen/Filter holder gaskets



| Abb. Pict. | Bestell-Nr. Order-No. | Beschreibung Description  | Gerätetyp Device type | Ver.-Nr. Com.-No. | Abb. Pict. | Bestell-Nr. Order-No. | Beschreibung Description  | Gerätetyp Device type | Vergl.-Nr. Comp.-No. |
|------------|-----------------------|---|-----------------------|-------------------|------------|-----------------------|---|-----------------------|----------------------|
| 1          | 528046                | Distanzeinlage/alt<br>Shirm gasket/old  |                       |                   | 4          | 528042                | Siebträgerdichtung,<br>72 x 56 x 8,5mm<br>Holder gasket,<br>73 x 56 x 8mm |                       | 12217                |
| 2          | 528043                | Siebträgerdichtung/alt,<br>66 x 56 x 6mm<br>Holder gasket/old,<br>66 x 56 x 6mm |                       |                   | 5          | 528063                | Siebträgerdichtung,<br>72 x 56 x 8mm<br>Holder gasket,<br>72 x 56 x 8mm   |                       | 12215                |
| 3          | 528050                | Distanzeinlage/neu<br>Shirm gasket/new  |                       |                   | 6          | 529084                | Dusche<br>Shower  |                       | 27100                |

## Siebe/Filter



| Abb. Pict. | Bestell-Nr. Order-No. | Beschreibung Description               | Gerätetyp Device type | Vergl.-Nr. Comp.-No. | Abb. Pict. | Bestell-Nr. Order-No. | Beschreibung Description                   | Gerätetyp Device type | Vergl.-Nr. Comp.-No. |
|------------|-----------------------|--|-----------------------|----------------------|------------|-----------------------|--|-----------------------|----------------------|
| 1          | 529024                | Reinigungsmembran<br>Cleaning membran  |                       |                      | 4          | 529012                | Sieb/1 Tasse (6g)<br>Filter/1 cup (6g)     |                       |                      |
| 2          | 529023                | Blindfilter<br>Blindfilter             |                       | 27173                | 4          | 529011                | Sieb/1 Tasse (7g)<br>Filter/1 cup (7g)     |                       |                      |
| 3          | 529079                | Siebträgerfeder<br>Filterholder spring |                       | 27254                | 5          | 529014                | Sieb/2 Tassen (12g)<br>Filter/2 cups (12g) |                       |                      |
|            |                       |  |                       |                      | 5          | 529013                | Sieb/2 Tassen (14g)<br>Filter/2 cups (14g) |                       |                      |

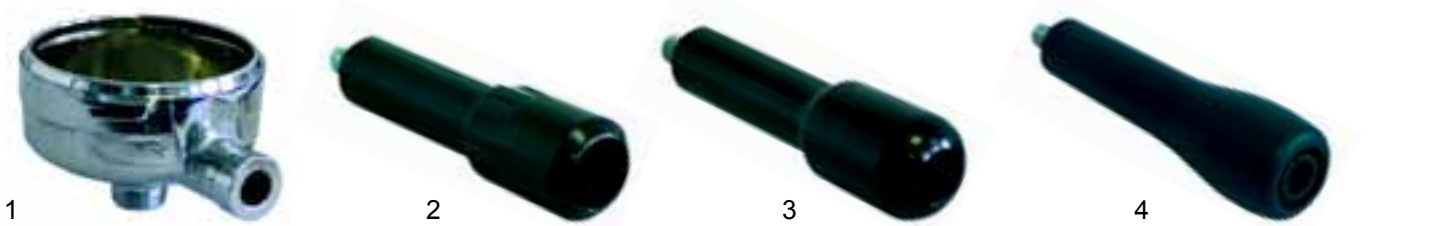

| Abb. Pict. | Bestell-Nr. Order-No. | Beschreibung Description                        | Gerätetyp Device type | Ver.-Nr. Com.-No. | Abb. Pict. | Bestell-Nr. Order-No. | Beschreibung Description                        | Gerätetyp Device type | Ver.-Nr. Com.-No. |
|------------|-----------------------|---|-----------------------|-------------------|------------|-----------------------|---|-----------------------|-------------------|
| 1          | 529059                | Siebträger, M12<br>Filterholder, M12            |                       | 27304             | 3          | 529045                | Siebträgergriff M12<br>Filterholder handle, M12 |                       |                   |
| 2          | 529044                | Siebträgergriff M12<br>Filterholder handle, M12 |                       | 15262             | 4          | 111150                | Siebträgergriff M12<br>Filterholder handle, M12 |                       | 15263010          |



## Siebträgerdichtungen/Filter holder gaskets



| Abb. Pict. | Best.-Nr. Ord.-No. | Beschreibung Description                                   | Gerätetyp Device type | V.-Nr. C.-No.  |
|------------|--------------------|--|-----------------------|----------------|
| 1          | 529001             | Auslauf 3/8", 1 Weg gerade<br>Spout 3/8", one way straight |                       |                |
| 2          | 529004             | Auslauf 3/8", 1 Weg gebogen<br>Spout 3/8", one way curved  |                       | 27030<br>27032 |

| Abb. Pict. | Best.-Nr. Ord.-No. | Beschreibung Description                                  | Gerätetyp Device type | V.-Nr. C.-No.  |
|------------|--------------------|---|-----------------------|----------------|
| 3          | 529003             | Auslauf 3/8", 1 Weg gebogen<br>Spout 3/8", one way curved |                       |                |
| 4          | 529007             | Auslauf 3/8", 2 Wege kurz<br>Spout 3/8", two way short    |                       | 27041<br>27042 |

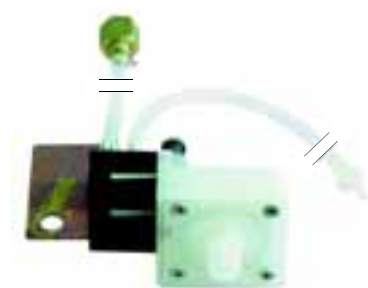

| Pos. Item | Best.-Nr. Ord.-No. | Beschreibung Description                  | Gerätetyp Device type | Vergl.-Nr. Comp.-No. |
|-----------|--------------------|---|-----------------------|----------------------|
| 1         | 802108             | Milchaufschäumer/kpl.<br>Milk foamer/cpl. |                       | 83300000             |